

FIG.19

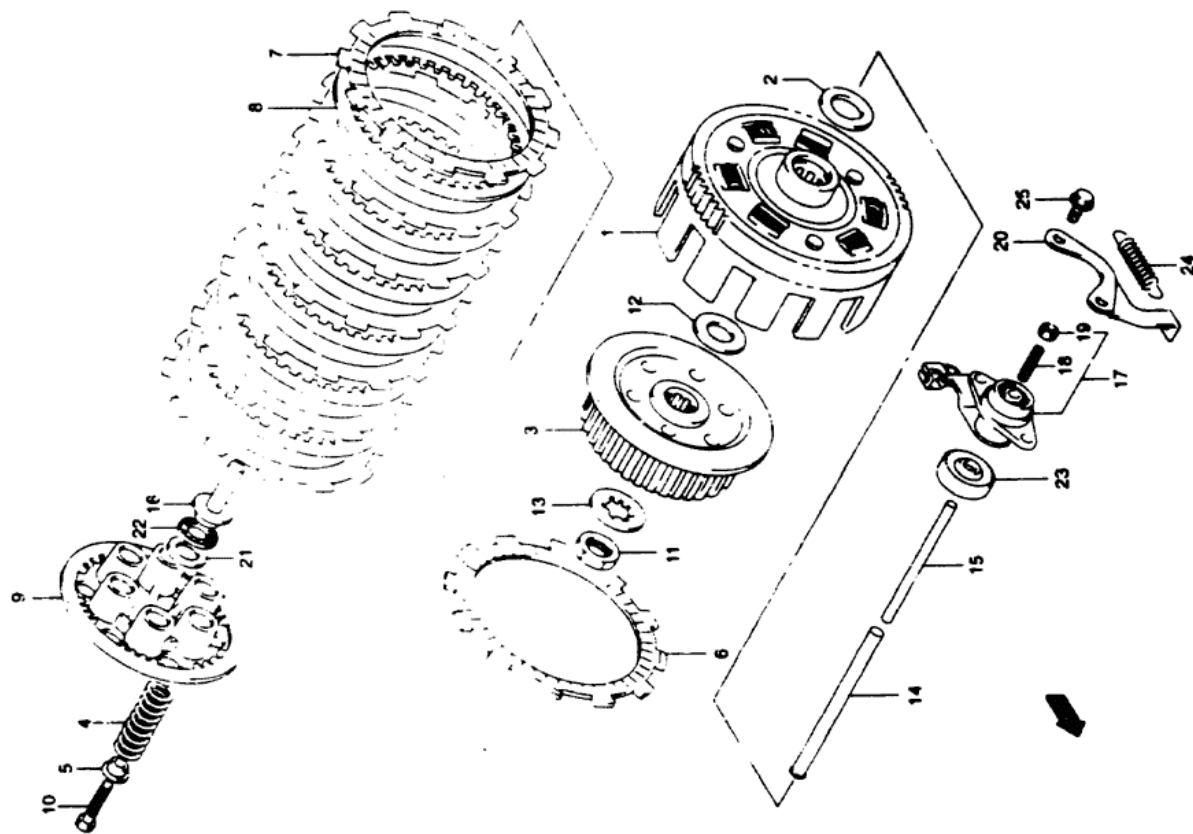

FIG 19 (D-9)

CLUTCH

REF.NO.	PART NO.	DESCRIPTION	Q'TY	REMARKS
1-1	21200-20810	GEAR ASSY. PRIMARY DRIVEN	1	-E NO P503-106336
1-2	21200-20811	GEAR ASSY. PRIMARY DRIVEN	1	E NO P503-106337-
2	09160-20067	WASHER (20X36X3)	1	
3	21411-44101	HUB CLUTCH SLEEVE	1	
4	21413-20F00	SPRING CLUTCH	5	
5	21414-01D00	SPACER CLUTCH SLEEVE HUB	6	
6	21440-19F00	PLATE CLUTCH DRIVE	1	
7	21441-37440	PLATE CLUTCH DRIVE	6	
8	21451-28C31	PLATE CLUTCH DRIVEN (T 16)	6	
9	21462-14301	DISC CLUTCH PRESSURE	1	
10	09100-06145	BOLT (6X40)	6	
11	09140-20001	NUT	1	
12	04160-20067	WASHER (20X36X3)	1	
13	09167-20006	LOCK WASHER	1	
14	23110-44111	ROD PUSH RH	1	
15	23111-27401	ROD CLUTCH PUSH LH	1	
16	23121-44100	PIECE CLUTCH PUSH	1	
17	23200-11D00	SCREW ASSY CLUTCH RELEASE	1	
18	09134-06010	SCREW	1	
19	08310-00067	NUT	1	
20	23226-19F00	SUPPORT CLUTCH RELEASE	1	
21	09160-15045	WASHER (15.5X28X1)	1	
22	99263-15003	BEARING (15X28X2)	1	
23	09285-06015	OIL SEAL (6X34X5.5)	1	
24	09443-78001	SPRING	1	
25	U1500-06163	BOLT	2	

22 SV650 Y E3/E33

D9